

RC02 testing bench - setup and connection for E-BM-AES

1 INSTALLATION TOOLS

CODE	DESCRIPTION	NOTE
E-C-SB-USB/BM	USB cable	
E-A-SB-USB/OPT	USB isolator adapter	Highly recommended for PC protection
ESP-RC02-P	Programmable DC Power Supply - RIGOL DP832	
ESP-RC02-M	RC02-M - Main Test Bench	
ESP-RC02-I1	RC02-I1 - Interface 1 Test Bench	
ESP-RC02-C-POWER-RB	24VDC power supply cables	4 single (2 red and 2 black cables)
ESP-RC02-C-COILS-I1-02	Coils connection cable	Multicable
ESP-RC02-C-I1-X-01	Connections cable	Multicable



WARNING! The RC02-M must be switched off before to connect or disconnect the interface test bench RC02-I*

2 RC02-I1 TEST BENCH POWER SUPPLY CONNECTION

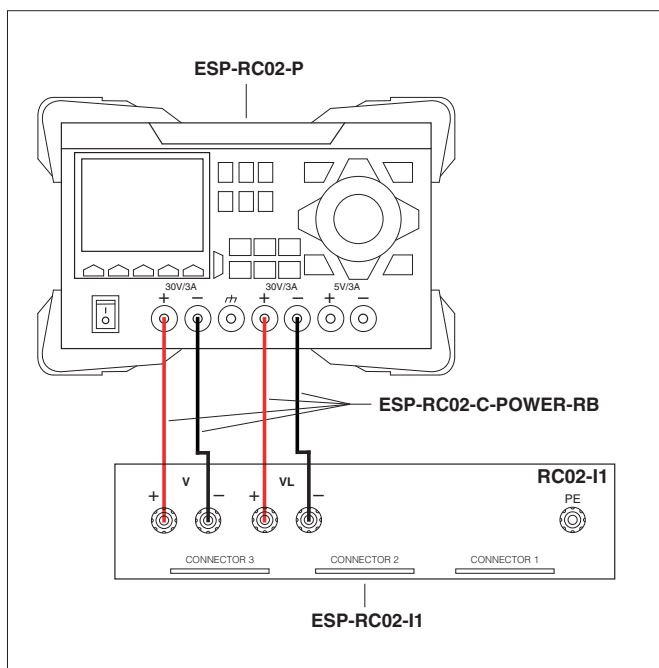

3 RC02-M AND RC02-I1 TEST BENCHES CONNECTION

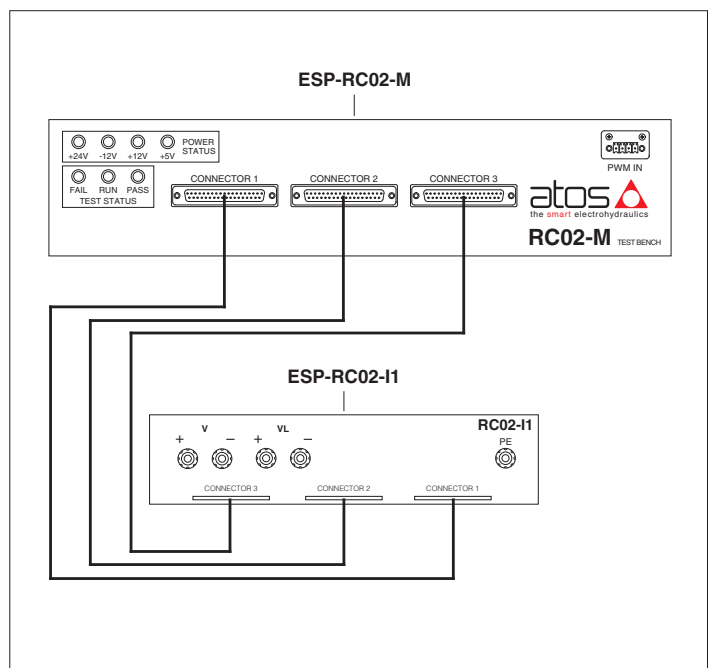

4 COIL(S) CONNECTION

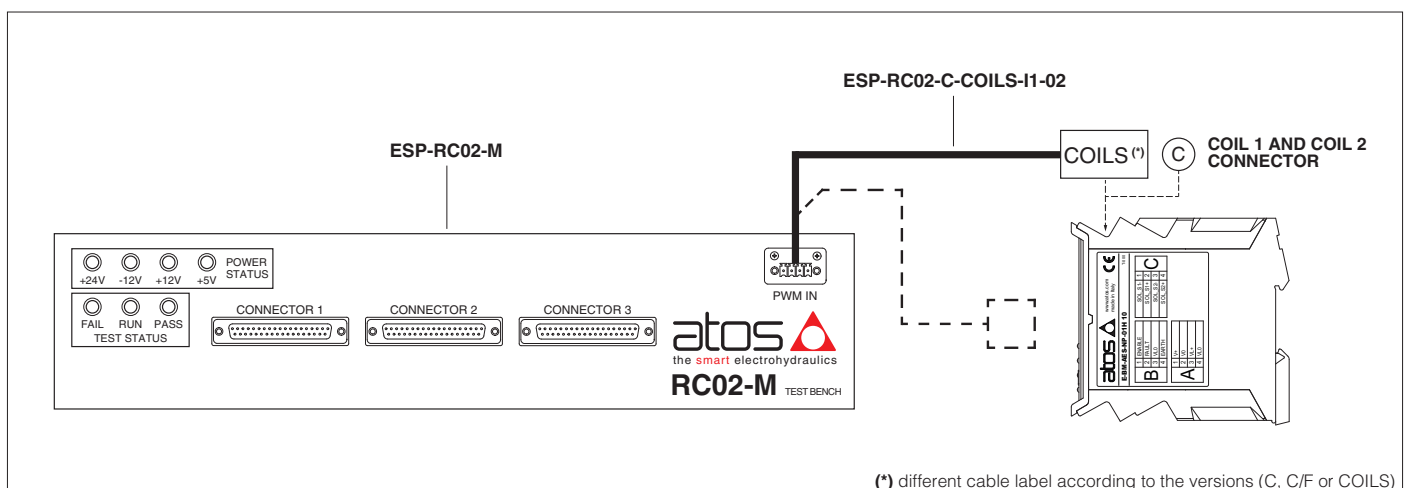

(*) different cable label according to the versions (C, C/F or COILS)

5 MAIN CONNECTIONS

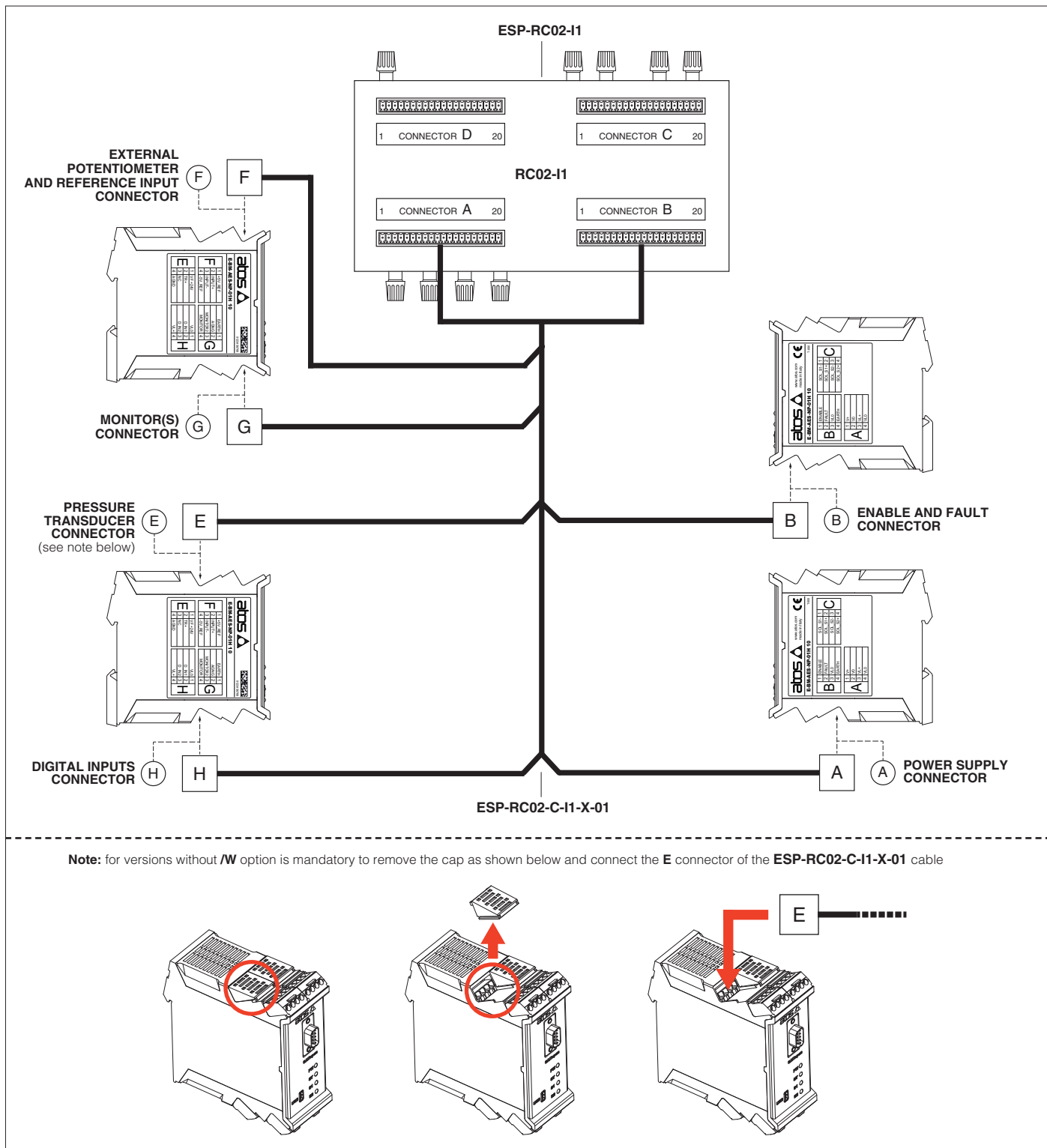

6 DRIVER TO PC CONNECTION

