

# RC02 testing bench - setup and connection for E-BM-TEB-N-NP-\*\*\*P

## 1 INSTALLATION TOOLS

CODE	DESCRIPTION	NOTE
E-C-SB-USB/BM	USB cable	
E-A-SB-USB/OPT	USB isolator adapter	Highly recommended for PC protection
ESP-RC02-P	Programmable DC Power Supply - RIGOL DP832	
ESP-RC02-M	RC02-M - Main Test Bench	
ESP-RC02-I1	RC02-I1 - Interface 1 Test Bench	
ESP-RC02-C-POWER-RB	24VDC power supply cables	4 single (2 red and 2 black cables)
ESP-RC02-C-COILS-I1-02	Coils connection cable	Multicable
ESP-RC02-C-I1-B-02	Connections cable	Multicable
ESP-RC02-C-I1-X-03	Connections cable	Multicable



**WARNING!** The RC02-M must be switched off before to connect or disconnect the interface test bench RC02-I\*

## 2 RC02-I1 TEST BENCH POWER SUPPLY CONNECTION

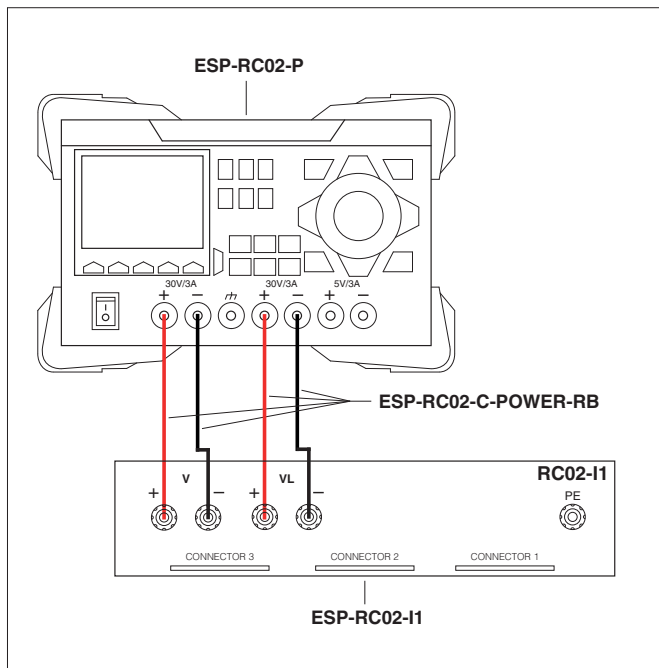

## 3 RC02-M AND RC02-I1 TEST BENCHES CONNECTION

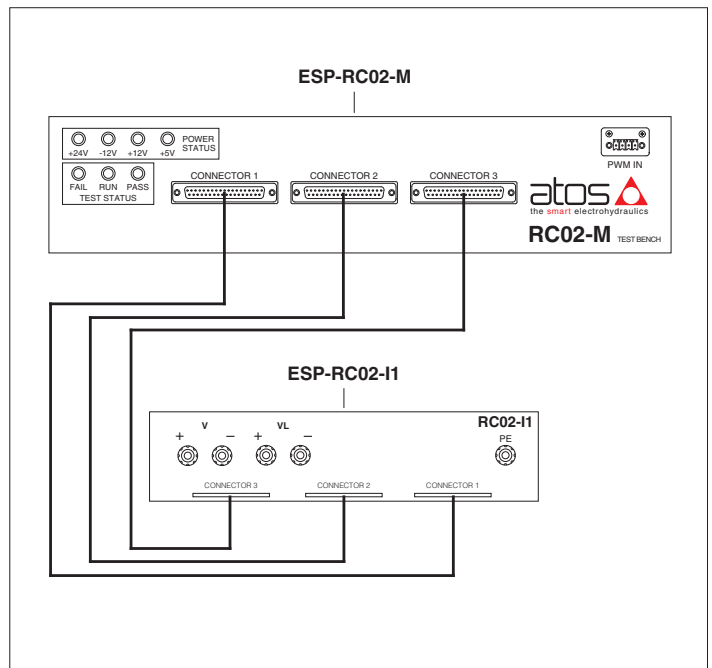

## 4 COIL(S) CONNECTION

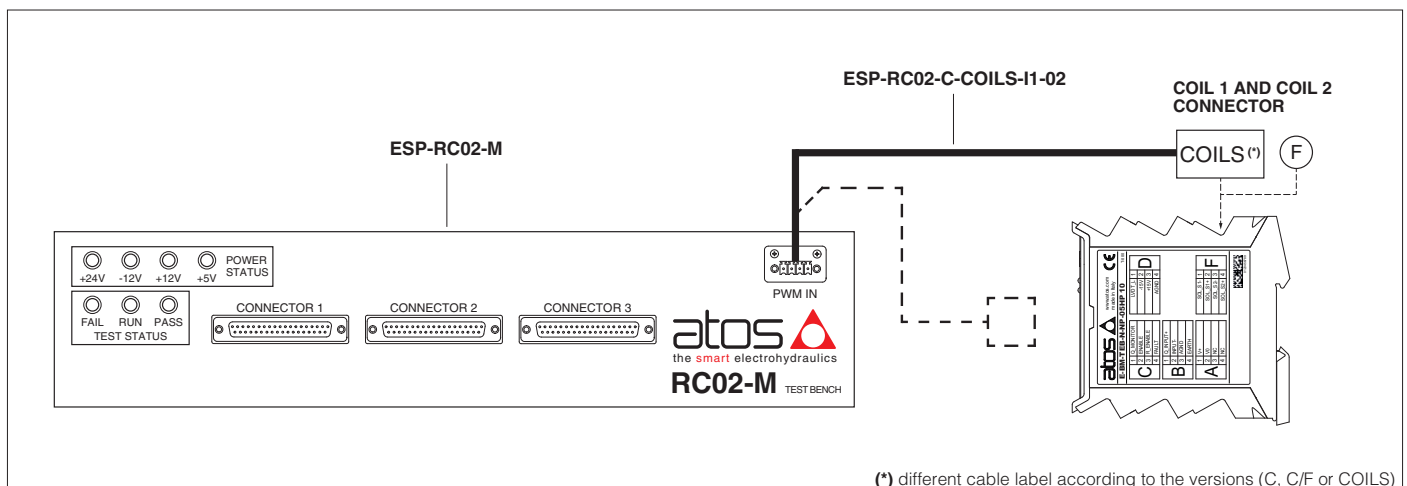

(\*) different cable label according to the versions (C, C/F or COILS)

## 5 MAIN CONNECTIONS

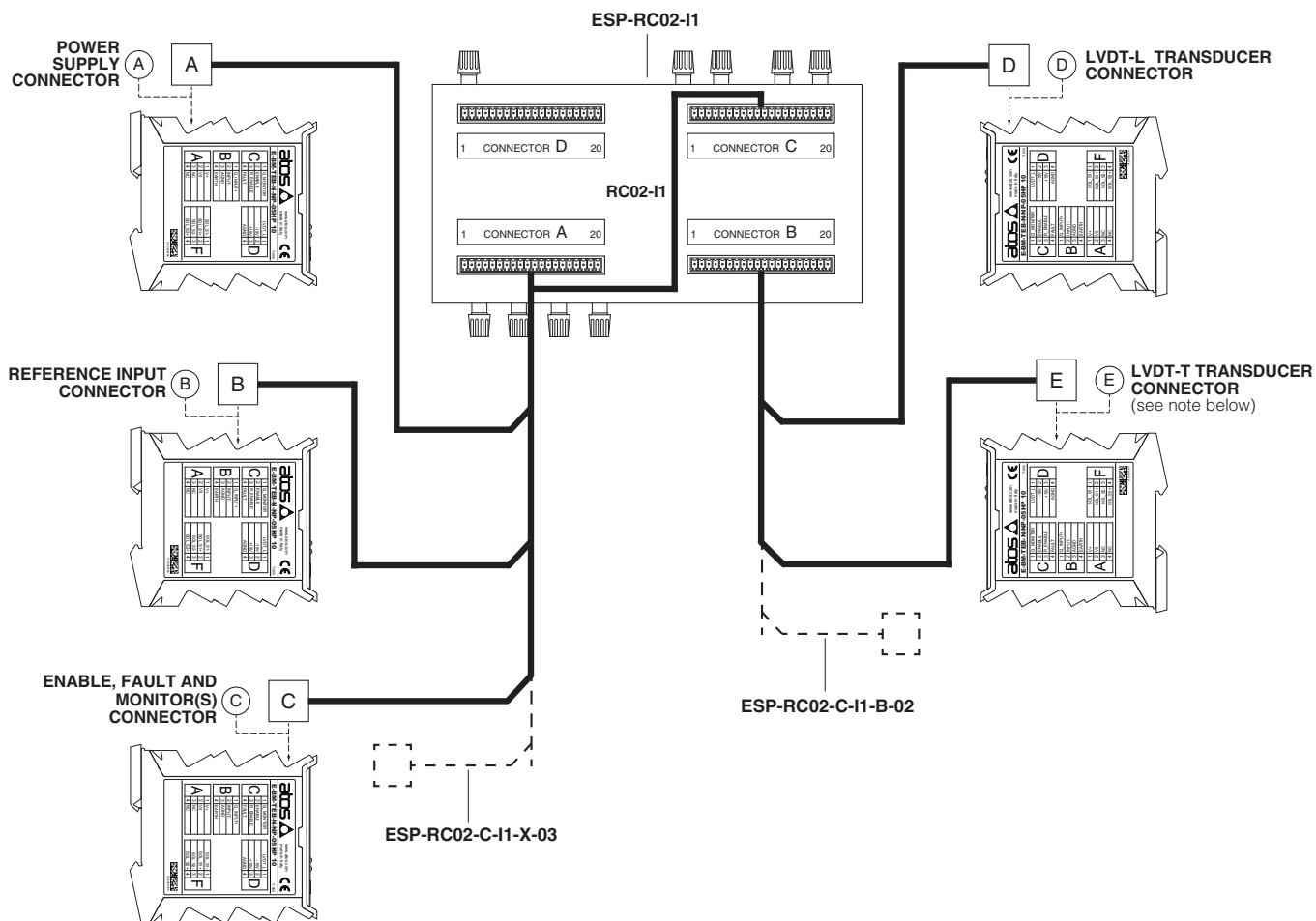

**Note:** for TEB versions with P option is mandatory to remove the cap as shown below and connect the E connector of the ESP-RC02-C-I1-B-02 cable

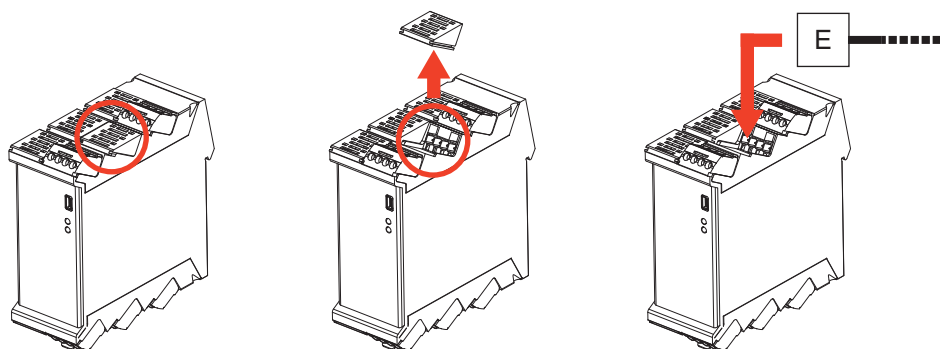

## 6 DRIVER TO PC CONNECTION

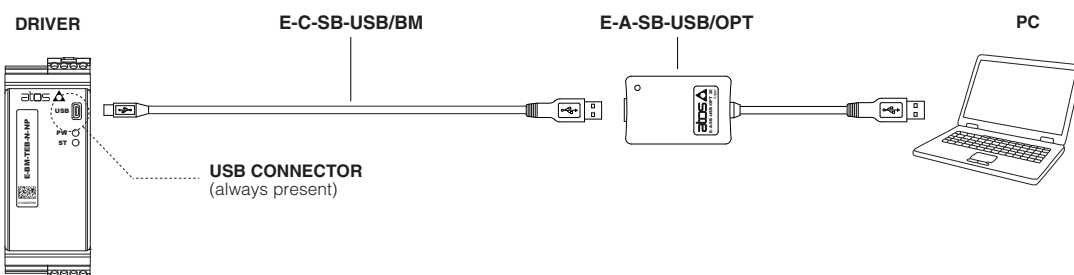

**WARNING:** drivers USB port is not isolated! The use of isolator adapter is highly recommended for PC protection (see table GS500)