

RC02 testing bench - setup and connection for E-ME-AC

1 INSTALLATION TOOLS

CODE	DESCRIPTION	NOTE
ESP-RC02-P	Programmable DC Power Supply - RIGOL DP832	
ESP-RC02-M	RC02-M - Main Test Bench	
ESP-RC02-I2	RC02-I2 - Interface 2 Test Bench	
ESP-RC02-C-POWER-RB	24VDC power supply cables	4 single cables (2 red and 2 black cables)
ESP-RC02-C-COILS-I2-01	Coils connection cable	Single cable
ESP-RC02-C-I2-X-02	Monitor connection cable	Single cable
ESP-RC02-C-PE-02	PE cable	Single cable

WARNING! The RC02-M must be switched off before to connect or disconnect the interface test bench RC02-I*

2 SETUP - Attention: to start the testing procedure proceed with the settings below:

Rotate the **RAMPS** screws in CCW until zero position

Rotate the **SCALES** screws in CCW until zero position

E-ME-AC-05F TOPOGRAPHICAL VIEW OF REGULATIONS

Card disabled led

References potentiometer and ramps regulation leds

1) Reference potentiometer
Ramp regulation
Reference potentiometer
Ramp regulation
Reference potentiometer
Ramp regulation
Reference potentiometer
Ramp regulation

2) Drive enabled led (solenoid S1)
Bias solenoid S1
Scale adjust for solenoid S1

Drive enabled led (solenoid S2)
Bias solenoid S2
Scale adjust for solenoid S2

Current monitor point (mV read = mA)

Acceleration and deceleration ramp
Deceleration ramp (only for /RR option)

1) Reference pot. P1, P2, P3, P4 mounted in -4, /RR-4, /4R-4 options
Ramps pot. P11, P12, P13, P14 mounted only in /4R-4 option

2) Only for E-ME-AC-05F/*

L7

L1, L2, L3, L4

P1

P11

P2

P12

P3

P13

P4

P14

L5

P5

P15

L6

P6

P16

P7

P17

3 RC02-I2 TEST BENCH POWER SUPPLY CONNECTION

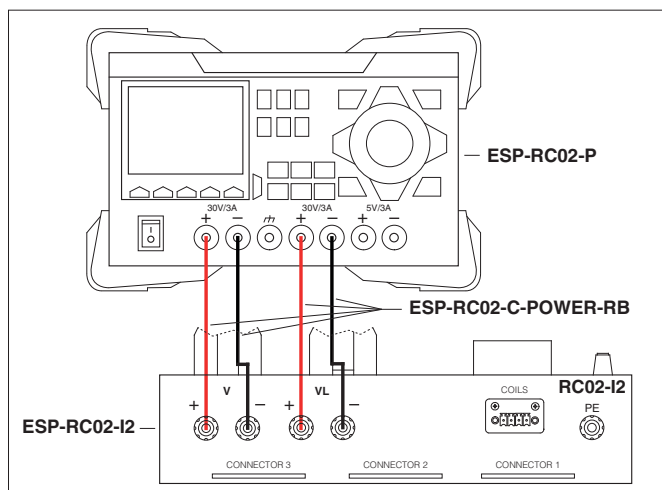

4 RC02-M AND RC02-I2 TEST BENCHES CONNECTION

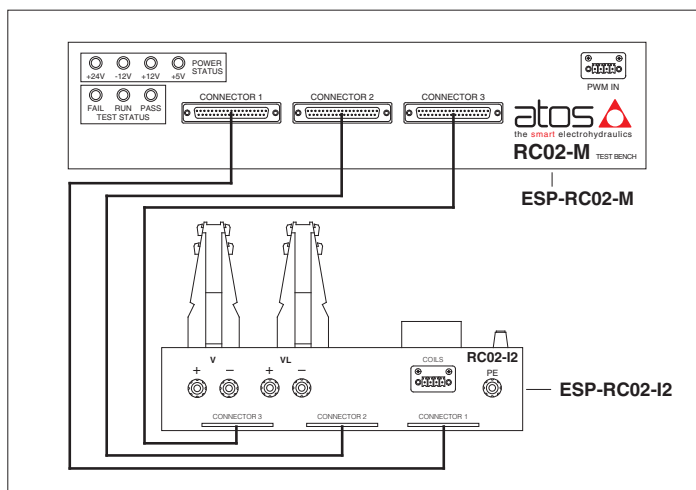

5 COILS CONNECTION

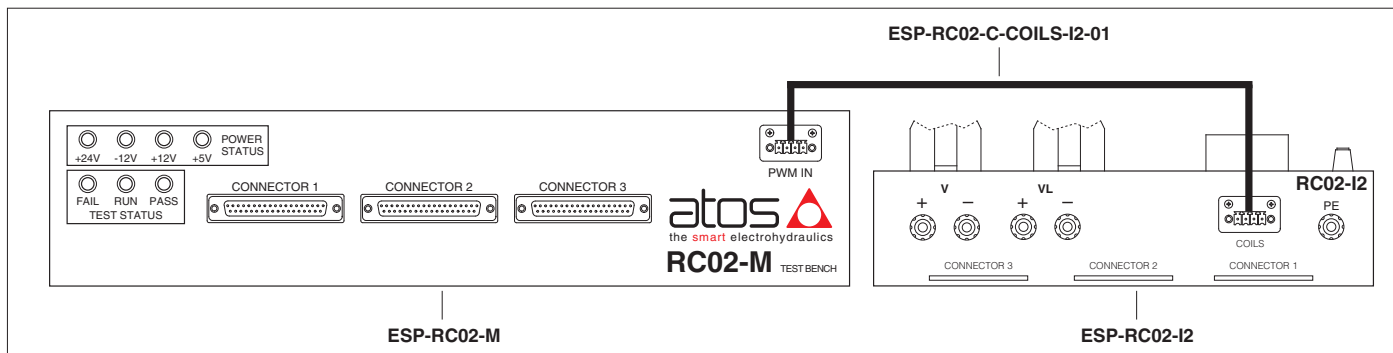

6 MAIN CONNECTIONS

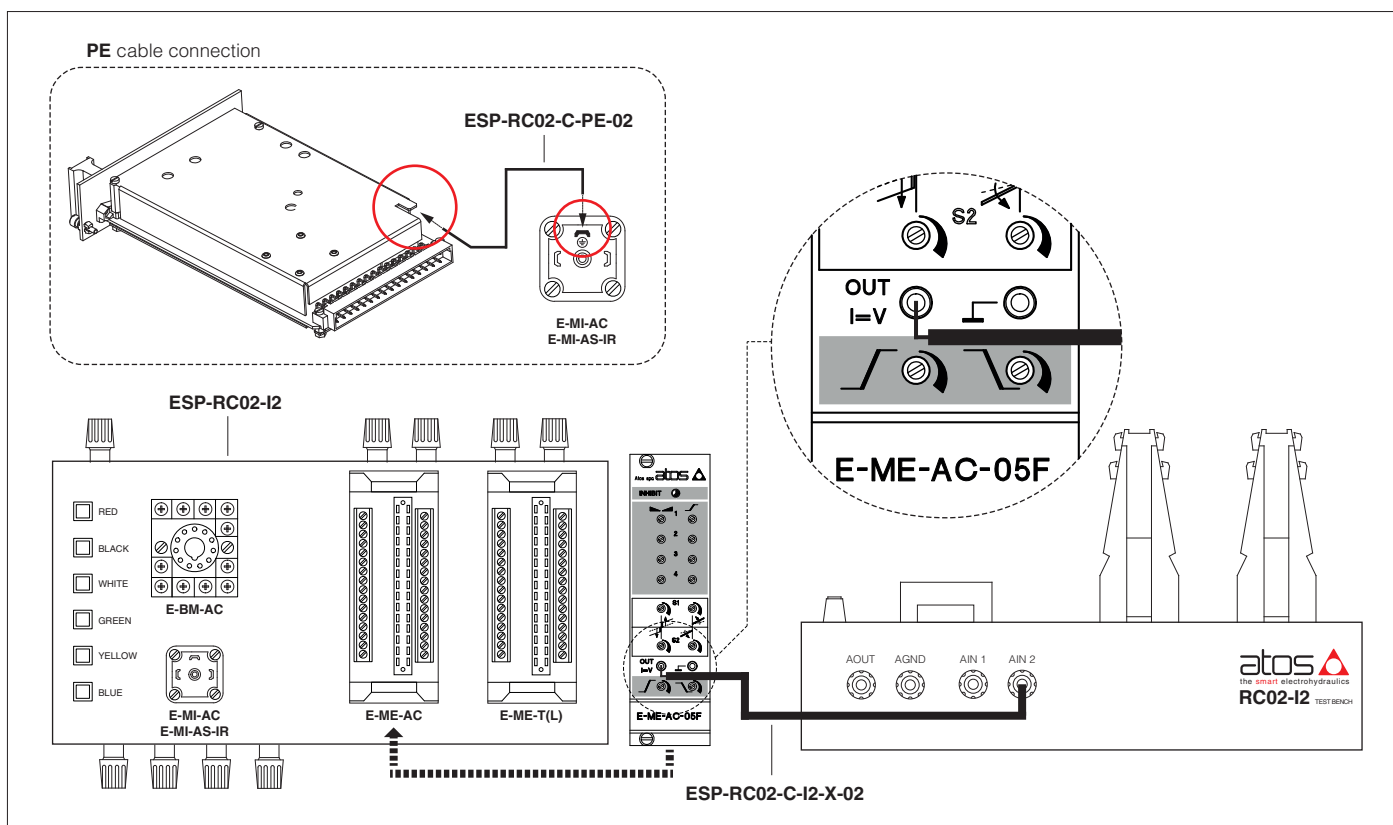

7 CALIBRATION - only for "Test & Calibration" procedure

Follow this procedure only if strictly necessary: set the PWM frequency and/or monitor signals when their values are out of range.

Use **PT8** trimmer to set PWM FREQUENCY

When the access to **PT8** trimmer is required by the software, insert a small straight screwdriver into the hole shown below, without remove the cover.

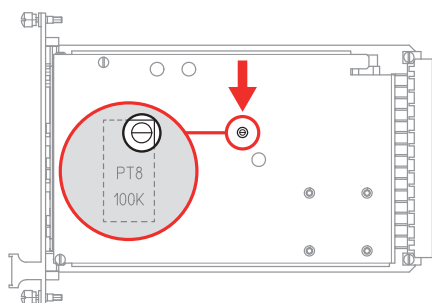

Use **PT9** trimmer to set monitor signal output according to the current supplied

When the access to **PT9** trimmer is required by the software, remove the 2 screws and the 4 rivets of driver's cover as shown at side.

WARNING: the removing of the cover is difficult! Handle carefully to avoid damaging the card.

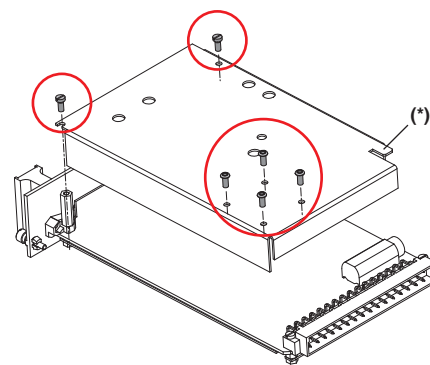
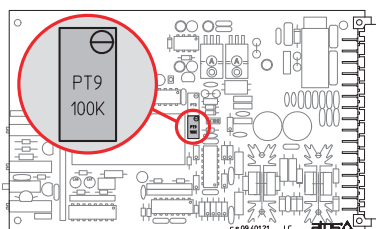

(*) the ESP-RC02-C-PE-02 cable has not be connected